

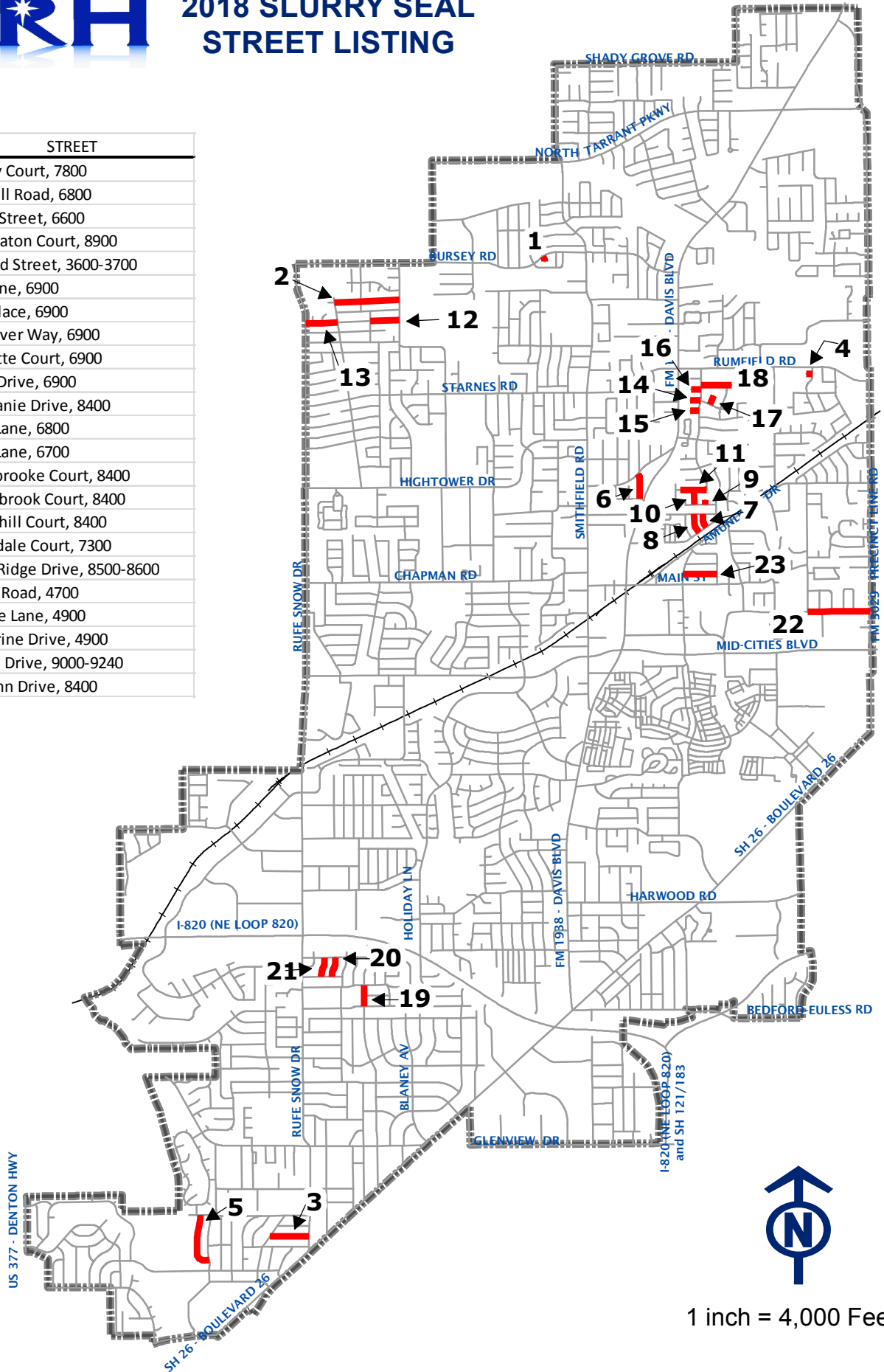

2018 SLURRY SEAL STREET LISTING

NUM	STREET
1	Burse Court, 7800
2	Old Mill Road, 6800
3	Marie Street, 6600
4	Boca Raton Court, 8900
5	Holland Street, 3600-3700
6	Cox Lane, 6900
7	Kara Place, 6900
8	Westover Way, 6900
9	Ruthette Court, 6900
10	Tessa Drive, 6900
11	Stephanie Drive, 8400
12	Moss Lane, 6800
13	Moss Lane, 6700
14	Stonybrooke Court, 8400
15	Springbrook Court, 8400
16	Springhill Court, 8400
17	Stonedale Court, 7300
18	Royal Ridge Drive, 8500-8600
19	Vance Road, 4700
20	Wilhite Lane, 4900
21	Katherine Drive, 4900
22	Martin Drive, 9000-9240
23	Glenann Drive, 8400



**CITY OF NORTH RICHLAND HILLS
PUBLIC WORKS DEPARTMENT
2018 SLURRY SEAL STREET LISTING**

NO	Condition Rating	STREET	LENGTH/ WIDTH	TOTAL SQUARE YARDS	ACCUMULATIVE TOTAL OF SQUARE YARDS	SLURRY SEAL \$2.40/SY	TOTAL ESTIMATED COST	ACCUMULATIVE COST TOTAL
1	86	Bursey Court, 7800 Bursey Road - Cul-de-sac	125 x 37	560	560	\$1,344	\$1,344	\$1,344
2	62	Old Mill Road, 6800 Crosstimbers Lane-Douglas Lane	1800 x 27	5,400	5,960	\$12,960	\$12,960	\$14,304
3	45	Marie Street, 6600 Rufe Snow Drive-Charles Street	1050 x 27	3,150	9,110	\$7,560	\$7,560	\$21,864
4	85	Boca Raton Court, 8900 Boca Raton Drive - Cul-de-sac	250 x 27	795	9,905	\$1,908	\$1,908	\$23,772
5	65	Holland Drive, 3600-3700 Billie Faye Drive-Onyx Drive North	1500 x 27	4,500	14,405	\$10,800	\$10,800	\$34,572
6	78	Cox Lane, 6900 Turner Drive-Cross Drive	700 x 27	2,100	16,505	\$5,040	\$5,040	\$39,612
7	78	Kara Place, 6900 Crystal Lane-Odell Street	380 x 27	1,140	17,645	\$2,736	\$2,736	\$42,348
8	84	Westover Way, 6900 Crystal Lane-Odell Street	500 x 27	1,500	19,145	\$3,600	\$3,600	\$45,948
9	73	Ruthette Court, 6900 Ruthette Drive-Cul-de-sac	200 x 27	645	19,790	\$1,548	\$1,548	\$47,496
10	56	Tessa Drive, 6900 Ruthette Drive-Stephanie Drive	400 x 27	1,200	20,990	\$2,880	\$2,880	\$50,376
11	51	Stephanie Drive, 8400 Stonybrooke Drive-Stephanie Drive	800 x 27	2,400	23,390	\$5,760	\$5,760	\$56,136
12	67	Moss Lane, 6800 Douglas Lane-Meadowview Terrace	815 x 27	2,445	25,835	\$5,868	\$5,868	\$62,004
13	67	Moss Lane, 6700 Rufe Snow Drive-Crosstimbers Lane	875 x 27	2,625	28,460	\$6,300	\$6,300	\$68,304
14	60	Stoneybrooke Court, 8400 Stonybrooke Drive-Culdesac	300 x 27	945	29,405	\$2,268	\$2,268	\$70,572
15	57	Springbrook Court, 8400 Stonybrooke Drive-Culdesac	250 x 27	795	30,200	\$1,908	\$1,908	\$72,480
16	60	Springhill Court, 8400 Stonybrooke Drive-Culdesac	300 x 27	945	31,145	\$2,268	\$2,268	\$74,748
17	60	Stonedale Court, 7300 Rockdale Drive-Culdesac	300 x 27	945	32,090	\$2,268	\$2,268	\$77,016
18	62	Royal Ridge Drive, 8500-8600 Stonybrooke Drive-Meadowbrook Drive	800 x 27	2,400	34,490	\$5,760	\$5,760	\$82,776
19	70	Vance Road, 4800 Marilyn Lane-Shauna Drive	570 x 27	1,710	36,200	\$4,104	\$4,104	\$86,880
20	87	Wilhite Lane, 4900 Corona Drive-Karen Drive	500 x 27	1,500	37,700	\$3,600	\$3,600	\$90,480
21	73	Katherine Drive, 4900 Corona Drive-Karen Drive	500 x 27	1,500	39,200	\$3,600	\$3,600	\$94,080
22	78	Martin Drive, 9000-9200 Precinct Line Road-Crane Road	1300 x 33	4,766	43,966	\$11,438	\$11,438	\$105,518
23	HA5	Glenann Drive, 8400 Sherri Lane-Amundson Drive	890 x 27	3,039	47,005	\$9,573	\$9,573	\$115,091
	68	TOTAL	6.4 Lane Miles	47,005	47,005	\$115,091	\$115,091	\$115,091