

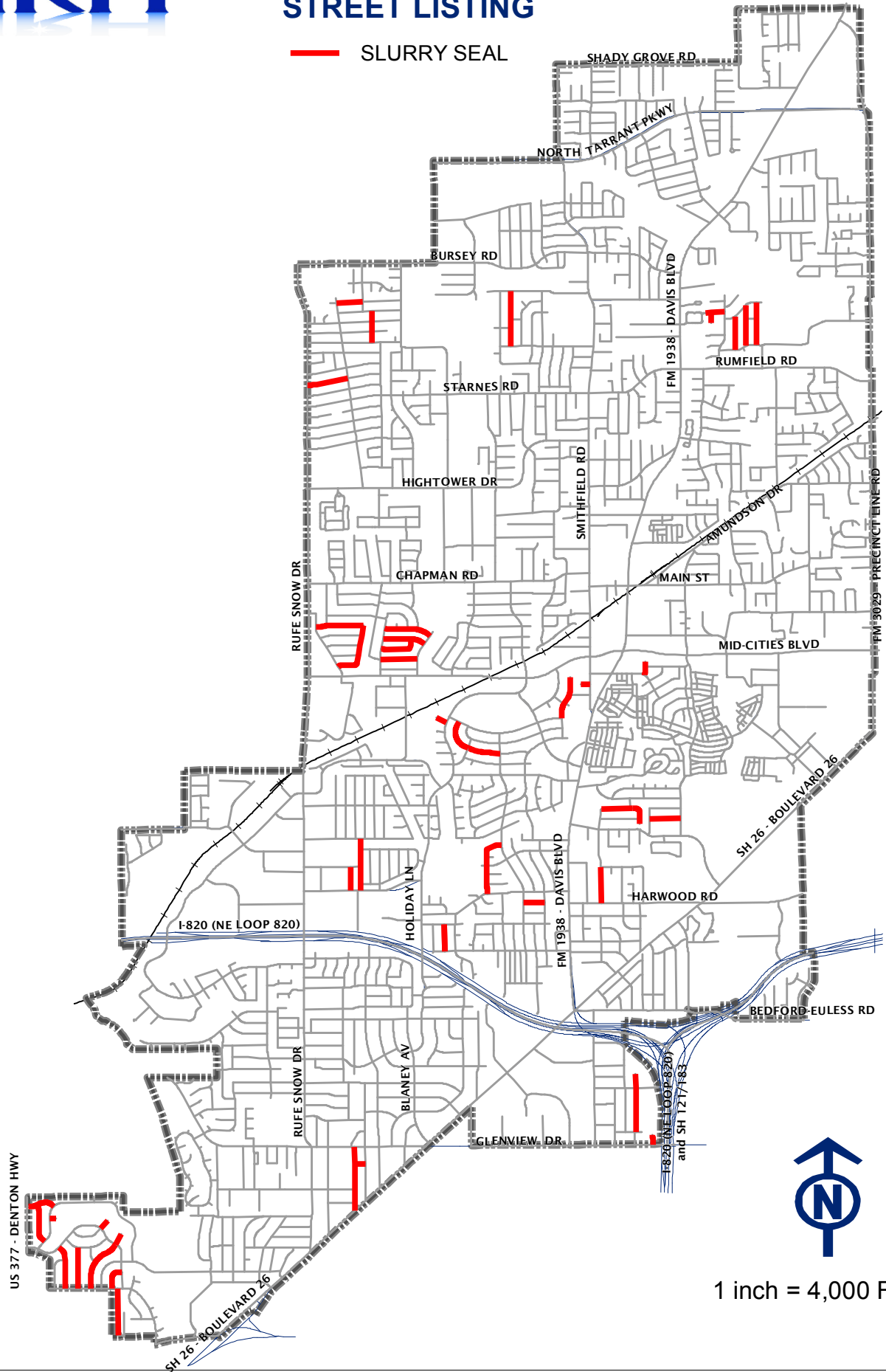

2016-2017 SLURRY SEAL STREET LISTING

 SLURRY SEAL



1 inch = 4,000 Feet

**CITY OF NORTH RICHLAND HILLS
PUBLIC WORKS DEPARTMENT
2016/2017 SLURRY SEAL STREET LISTING**

NO	Condition Rating	STREET	LENGTH/ WIDTH	TOTAL SQUARE YARDS	ACCUMULATIVE TOTAL OF SQUARE YARDS	SLURRY SEAL \$2.40/SY	TOTAL ESTIMATED COST
1	49	Reeves Street, 3500-3600 Webster Street-Tourist Drive	1250 x 27	3,750	3,750	\$9,000	\$9,000
2	36	Glenview Court, 4100 Glenview Drive-Apartment Complex	400 x 27	1,200	4,950	\$2,880	\$2,880
3	60	Garwood Drive, 3500-3600 Webster Street-Circular Drive	600 x 27	1,800	6,750	\$4,320	\$4,320
4	41	Cynthia Circle (Ct), 5900-5917 Tourist Drive - Culdesac	300 x 27	975	7,725	\$2,340	\$2,340
5	74	Sheridon Court, 3700 Tourist Drive - Culdesac	400 x 27	1,250	8,975	\$3,000	\$3,000
6	83	Scruggs Drive, 3800-4000 Boulevard 26-Glenview Drive	1780 x 27	5,340	14,315	\$12,816	\$12,816
7	61	Sheridon Drive, 3500-3600 Tourist Drive-Webster Street	1500 x 27	4,500	18,815	\$10,800	\$10,800
8	93	Cross Street, 6900 Scruggs Drive - Parchman Street	250 x 27	750	19,565	\$1,800	\$1,800
9	54	Lewis Court, 5500 Meadowcrest Drive-Dick Lewis Drive	650 x 27	1,950	21,515	\$4,680	\$4,680
10	77	Luther Court, 7300-7316 Holiday Lane - Culdesac	350 x 27	1,100	22,615	\$2,640	\$2,640
11	70	Maple Drive, 7300-7344 Bogart Drive-Whitfield Drive	900 x 27	2,700	25,315	\$6,480	\$6,480
12	50	Maple Drive, 7400-7440 Whitfield Drive-Susan Lee Lane	1050 x 27	3,150	28,465	\$7,560	\$7,560
13	74	Price Drive, 6100 / Split Section Bogart Drive-Dead End	1200 x 27	3,600	32,065	\$8,640	\$8,640
14	91	Cardinal Court, 7800-7836 Smithfield Road-Culdesac	300 x 27	945	33,010	\$2,268	\$2,268
15	79	Belfast Lane, 5600 Limerick Lane-Dead End	600 x 27	1,800	34,810	\$4,320	\$4,320
16	75	Limerick Lane, 7500 Kerry Lane-Galway Lane	850 x 27	2,550	37,360	\$6,120	\$6,120
17	44	Meadow Oak Drive, 5400-5500 Buenos Aires Drive - Dick Lewis Drive	1500 x 27	4,500	41,860	\$10,800	\$10,800
18	81	Keeter Drive, 4200-4400 Conn Drive - Dead End	1500 x 27	4,500	46,360	\$10,800	\$10,800
19	85	Northridge Blvd, 5300-5400 Harwood Road-Lynda Lane	1100 x 27	3,300	49,660	\$7,920	\$7,920
20	75	Karen Drive, 5100 Maplewood Avenue-Janetta Drive	730 x 27	2,190	51,850	\$5,256	\$5,256
21	89	Ford Drive, 7600 Terrell Drive-Kirk Lane	850 x 27	2,550	54,400	\$6,120	\$6,120
22	85	Dent Road, 5600-5700 Denton Highway -North Hills Drive	760 x 27	2,280	56,680	\$5,472	\$5,472
23	54	Matson Drive, 3700 Dent Road-North Hills Drive	1075 x 27	3,225	59,905	\$7,740	\$7,740
24	77	Scott Drive, 5300-5500 Lola Drive-Susan Lee Lane	1600 x 27	4,800	64,705	\$11,520	\$11,520
25	47	North Hills Court, 3700 North Hills Drive-Culdesac	400 x 27	1,200	65,905	\$2,880	\$2,880

**CITY OF NORTH RICHLAND HILLS
PUBLIC WORKS DEPARTMENT
2016/2017 SLURRY SEAL STREET LISTING**

26	65	Inwood Drive, 6700-6757 Crosstimbers Lane-Rufe Snow Drive	1077 x 27	3,231	69,136	\$7,754	\$7,754
27	68	Old Mill Drive, 6700-6800, Split Section Crosstimbers Lane-Western Oaks Drive	725 x 27	2,175	71,311	\$5,220	\$5,220
NO	Condition Rating	STREET	LENGTH/ WIDTH	TOTAL SQUARE YARDS	ACCUMULATIVE TOTAL OF SQUARE YARDS	SLURRY SEAL \$2.40/SY	TOTAL ESTIMATED COST
28	81	Meadowview Terrace, 7600-7700 Hickory Hollow Lane-Green Leaf Drive	1300 x 27	3,900	75,211	\$9,360	\$9,360
29	77	Amy Lane, 7700-7800 John Autry Road-Woodhaven Drive	1500 x 27	4,500	79,711	\$10,800	\$10,800
30	88	Gary Drive, 8500-8525 Dead End-Northfield Drive	500 x 27	1,500	81,211	\$3,600	\$3,600
31	71	Jill Court, 7600-7629 Gary Drive-Culdesac	300 x 27	900	82,111	\$2,160	\$2,160
32	80	O'Brian Way, 8200 Newman Drive-Cork Lane	850 x 27	2,550	84,661	\$6,120	\$6,120
33	81	Hunt Drive, 7600-7700 Kirk Lane-Terrell Drive	1000 x 27	3,000	87,661	\$7,200	\$7,200
34	55	Perkins Drive, 7600 Kirk Lane-Terrell Drive	1100 x 27	3,300	90,961	\$7,920	\$7,920
35	80	Oldham Place, 7100-7200 Yarmouth Avenue-Buckingham Trail	1300 x 27	3,900	94,861	\$9,360	\$9,360
36	84	Chatham Road, 7100-7200 Yarmouth Avenue-Buckingham Trail	1000 x 27	3,000	97,861	\$7,200	\$7,200
37	70	Winchester Road, 7100-7200 Yarmouth Avenue-Buckingham Trail	1100 x 27	3,300	101,161	\$7,920	\$7,920
38	72	Harwick Lane, 7100-7200 Yarmouth Avenue-Winchester Road	1050 x 27	3,150	104,311	\$7,560	\$7,560
39	79	Sunrise Drive, 6300-6500 Sunset Road-Glendale Drive	1700 x 27	5,100	109,411	\$12,240	\$12,240
40	88	Glendale Drive, 6800-6900 Sunrise Drive-Suset Road	1300 x 27	3,900	113,311	\$9,360	\$9,360
41	89	Sybil Drive, 7600 Roberta Drive-Susan Lee Lane	550 x 27	1,650	114,961	\$3,960	\$3,960
42	77	Freda Lane, 6300 Newman Drive-Dead End	300 x 27	900	115,861	\$2,160	\$2,160
43	49	Orient Drive, 3500 Tourist Drive-Webster Drive	630 x 27	1,890	117,751	\$4,536	\$4,536
44	80	Tourist Drive, 3301-3400 Haltom City Limits (Carson St)-Webster Street	1450x27	4,350	122,101	\$10,440	\$10,440
AVG	71	TOTAL	16.4 Lane Miles		122,101	\$293,042	