

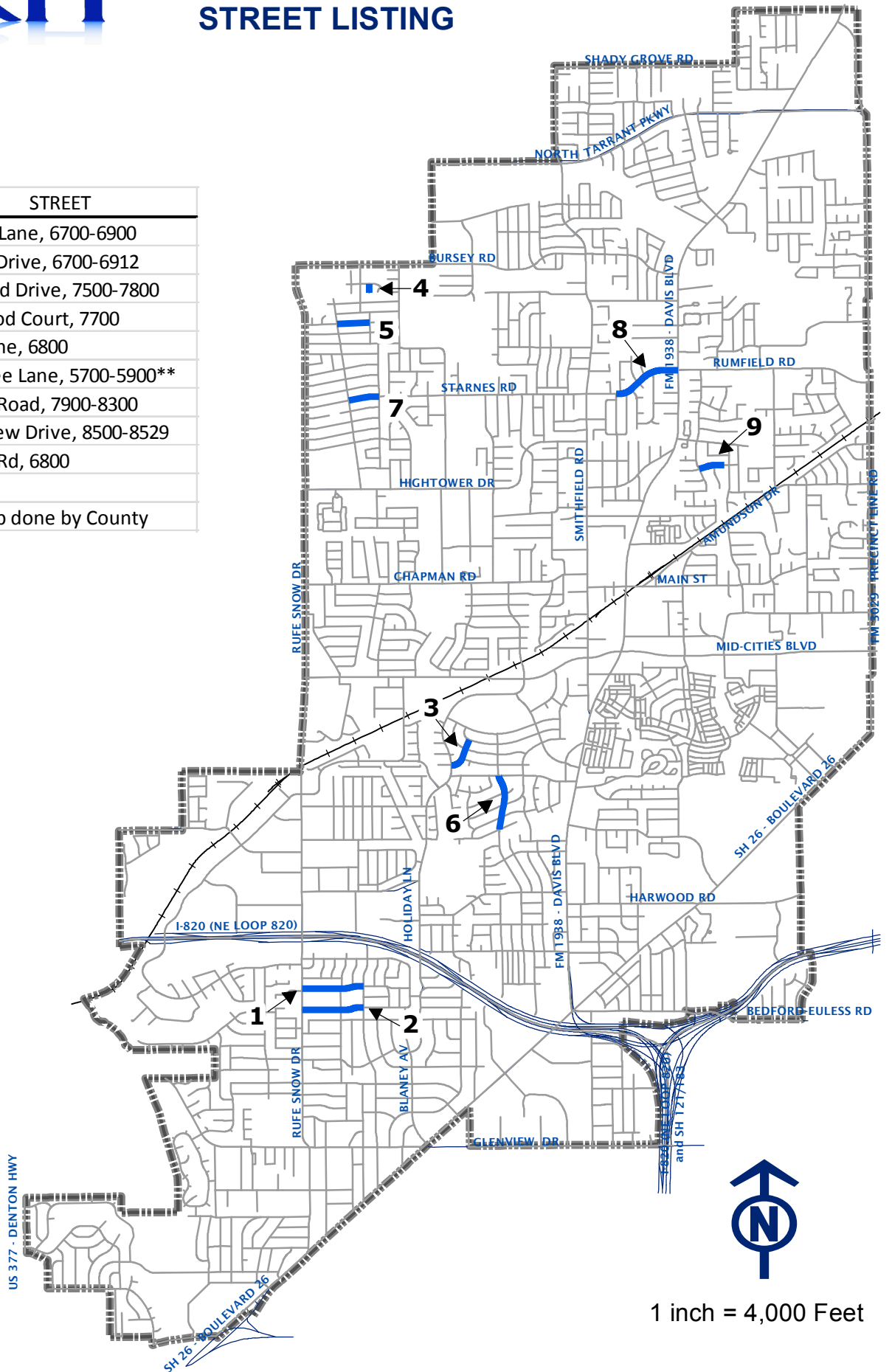

# 2018 2" HMAC OVERLAY STREET LISTING

NUM	STREET
1	Marilyn Lane, 6700-6900
2	Shauna Drive, 6700-6912
3	Whitfield Drive, 7500-7800
4	Driftwood Court, 7700
5	Moss Lane, 6800
6	Susan Lee Lane, 5700-5900**
8	Starnes Road, 7900-8300
9	Brookview Drive, 8500-8529
7	Starnes Rd, 6800
** Rehab done by County	



**CITY OF NORTH RICHLAND HILLS  
PUBLIC WORKS DEPARTMENT  
2 INCH HMAC OVERLAY BY CITY STAFF  
YEAR 2018**

<b>NO.</b>	<b>Condition Rating</b>	<b>STREET</b>	<b>LENGTH/ WIDTH</b>	<b>TOTAL SQUARE YARDS</b>	<b>ACCUMULATIVE SQUARE YARD TOTAL</b>	<b>2" HMAC OVERLAY COST</b>	<b>SUBGRADE &amp; CURB/GUTTER COST</b>	<b>TOTAL ESTIMATED COST</b>	<b>ACCUMULATIVE COST TOTAL</b>
1	60	<b>Marilyn Lane,6700-6900</b> Rufe Snow Drive-Vance Road	1710x27	5,130	5,130	\$36,279	\$60,591	\$96,870	\$96,870
2	71	<b>Shauna Drive,6700-6912</b> Rufe Snow Drive-Vance Road	1675x27	5,025	10,155	\$35,537	\$57,631	\$93,168	\$190,038
3	54	<b>Whitfield Drive,7500-7800</b> Holiday Lane-Deaver Drive	1000x27	3,000	13,155	\$21,217	\$52,796	\$74,013	\$264,051
4	30	<b>Driftwood Court,7700</b> Rolling Ridge Drive-Cul-de-sac	300x27	900	14,055	\$6,365	\$41,070	\$47,435	\$311,486
5	67	<b>Moss Lane,6800</b> Crosstimbers Drive-Meadowview Terrace	900x27	2,700	16,755	\$19,094	\$54,578	\$73,672	\$385,158
6	46	<b>Susan Lee Lane,5500-5700**</b> North Richland Boulevard-Circle Drive	1550x33	5,683	22,438	\$80,203	\$139,740	\$219,943	\$605,101
7	59	<b>Starnes Road,6800</b> Crosstimbers Lane-Meadowview Terrace	850x37	3,494	25,932	\$24,713	\$55,046	\$79,759	\$684,860
8	80	<b>Starnes Road,7900-8300</b> Crabtree Lane-Davis Boulevard	1950x37	8,017	33,949	\$56,694	\$40,921	\$97,615	\$782,475
9	46	<b>Brookview Drive,8500-8529</b> Stoneybrooke Drive-Herman Jared Drive	680x27	2,040	35,989	\$14,427	\$38,313	\$52,740	\$835,215
<b>Avg</b>	<b>57</b>	<b>TOTAL</b>	<b>LANE MILES</b>	<b>5.12</b>	<b>35,989</b>	<b>\$294,529</b>	<b>\$540,686</b>	<b>\$835,215</b>	<b>\$835,215</b>

\*\* Rehab done by County