

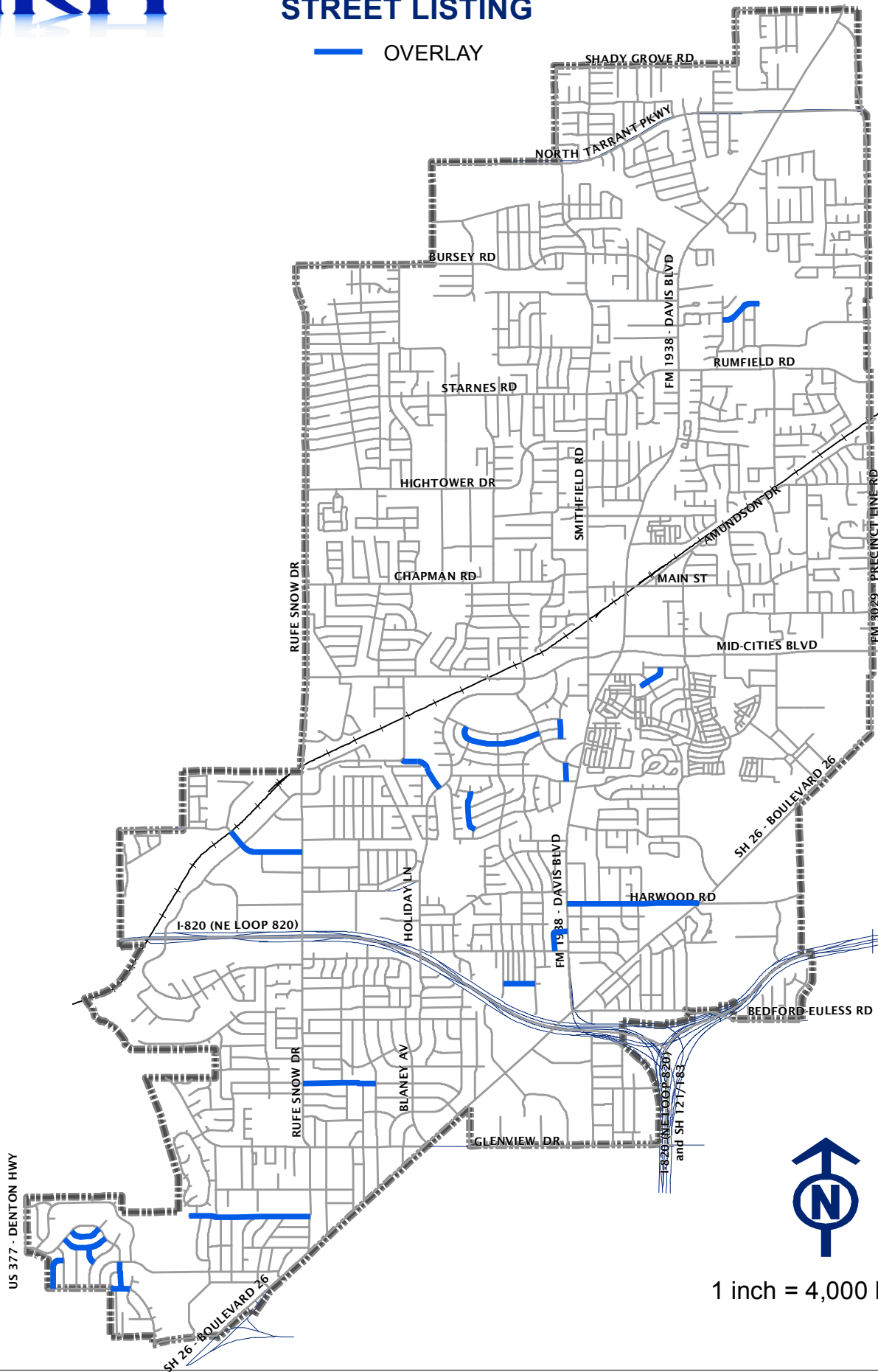

2016-2017 OVERLAY STREET LISTING

— OVERLAY



1 inch = 4,000 Feet

**CITY OF NORTH RICHLAND HILLS
PUBLIC WORKS DEPARTMENT
2 INCH HMAC OVERLAY BY CITY STAFF
YEAR 2016/2017**

NO.	Condition Rating	STREET	LENGTH/ WIDTH	TOTAL SQUARE YARDS	ACCUMULATIVE SQUARE YARD TOTAL	2" HMAC OVERLAY COST	SUBGRADE & CURB/GUTTER COST	TOTAL ESTIMATED COST	ACCUMULATIVE COST TOTAL
1	44	Commercial Drive-5100 Davis Boulevard-Maplewood Drive	820 X 27	2,460	2,460	\$17,397	\$14,840	\$32,237	\$32,237
2	46	Short Street-7500-7600 Cloyce Court-Nancy Lane	790 X 27	2,370	4,830	\$16,760	\$17,431	\$34,191	\$66,428
3	69	Carolyn Drive-5700-5800 Jean Ann Drive-Fieldstone Drive	1000 X 27	3,000	7,830	\$21,217	\$25,947	\$47,164	\$113,592
4	24	Deaver Drive-7300-7400 Susan Lee Lane-Bogart Drive	1200 X 27	3,600	11,430	\$25,460	\$40,744	\$66,204	\$179,796
5	66	Briley Drive-6700-6900 Vance Road-Rufe Snow Drive	2080 X 27	4,111	15,541	\$44,130	\$30,415	\$74,545	\$254,341
6	59	Harwood Road-7800-7900** Davis Boulevard-Bob Street	1450 X 45	7,250	22,791	\$59,100	\$66,518	\$125,618	\$379,959
7	18	Liberty Way-7300* Holiday Lane-Iron Horse Boulevard	1400 X 27	4,200	26,991	\$59,271	\$42,994	\$102,265	\$482,224
8	19	Deaver Drive-7500-7600* College Circle-Susan Lee Lane	1180 X 27	3,540	30,531	\$74,878	\$98,142	\$173,020	\$655,244
9	65	Terrell Drive,8500-8700 Northfield Drive-Dead End	1200x27	3,600	34,131	\$25,460	\$13,209	\$38,669	\$693,913
10	52	Browning Drive,6400-6600 Rufe Snow Drive-R/R Tracks (split section)	2100x37	8,633	42,764	\$61,055	\$23,120	\$84,175	\$778,088
11	51	Cynthia Circle, 5800 ** Tourist Drive-Tourist Drive	850x27	2,550	45,314	\$20,779	\$54,308	\$75,087	\$853,175
12	47	Northcut Drive, 3600 ** Sheridon Drive-Circular Drive	500x27	1,500	46,814	\$12,225	\$20,334	\$32,559	\$885,734
13	37	Price Drive, 6100 Bogart Drive-Terry Drive (split section)	600x27	1,800	48,614	\$12,729	\$29,444	\$42,173	\$927,907
14	74	Webster Street, 5800 ** Wendell Drive-Orient Drive	540x27	1,620	50,234	\$13,203	\$17,603	\$30,806	\$958,713
15	59	Circular Drive,5800 ** Tourist Drive-Tourist Drive	1350x27	4,050	54,284	\$33,000	\$25,670	\$58,670	\$1,017,383
16	82	Harwood Road,8000-8300 ** Bob Street-Boulevard 26	2200x45	11,000	65,284	\$89,650	\$45,620	\$135,270	\$1,152,653
17	49	Gayle Drive,6200 Pear Street-Culdesac	850x27	2,550	67,834	\$18,033	\$25,402	\$43,435	\$1,196,088
18	50	Paramount Street,3500 ** Reeves Street-Webster Street	1000x27	3,000	70,834	\$24,450	\$35,253	\$59,703	\$1,255,791
NO.	Condition Rating	STREET	LENGTH/ WIDTH	TOTAL SQUARE YARDS	ACCUMULATIVE SQUARE YARD TOTAL	2" HMAC OVERLAY COST	SUBGRADE & CURB/GUTTER COST	TOTAL ESTIMATED COST	ACCUMULATIVE COST TOTAL

**CITY OF NORTH RICHLAND HILLS
PUBLIC WORKS DEPARTMENT
2 INCH HMAC OVERLAY BY CITY STAFF
YEAR 2016/2017**

19	80	Tourist Drive,3500-3529 ** Webster Street-Bewley Street (To Concrete)	600x27	1,800	72,634	\$14,670	\$14,111	\$28,781	\$1,284,572
20	55	Oynx Drive North,6200-6600 ** Rufe Snow Drive-Dead End	3420x27	10,260	82,894	\$83,619	\$100,886	\$184,505	\$1,469,077
21	40	Ross Road,5800 College Circle-North Richland Boulevard	450x27	1,350	84,244	\$9,547	\$15,086	\$24,633	\$1,493,710
Avg	52	TOTAL	LANE MILES	12	84,244	\$736,633	\$757,077	\$1,493,710	\$1,493,710

*Sub-Grade Stabilization

**Reynolds Paving